RIIFO PVC RIGID CONDUIT



Revised on Dec 31, 2021

CATALOGUE INDEX

02

ABOUT RIIFO

04

INNOVATION

04

SCALE

05

RIIFO APPROVALS

06

PROJECT REFERENCE

12

RIIFO PVC RIGID CONDUIT

15 Application

15 Advantages

14

RIIFO CONDUIT FITTINGS

15

TECHNICAL DATA

15

STANDARDS

15 Technical Data

15 Standards

16

SPECIFICATIONS

16 RIIFO PVC Pipes

17 RIIFO PVC Fittings

26

INSTALLATION



ABOUT RIIFO

RIIFO is a leading multinational corporation, providing one-stop piping solutions applied in residential, commercial, agricultural, industrial, and infrastructural sectors. Relentless reinventing since 1996, with over 8,000 employees, 70 branches & subsidiaries, and 300,000 distributors, we have served customers in more than 100 countries and regions.

With an integrated value chain, from R&D to manufacturing and retail distribution, we strive to fulfill our mission of offering ideal piping products and services to everyone.

8,000

Employees

300,000

Distributors worldwide

100+

Serving over 100 countries & regions

70

Branches & Subsidiaries



INNOVATION

Believing that innovation is the key to go beyond the ordinary, RIIFO has founded one world-class lab recognized and certified by CNAS. Over 600 innovation talents have spared no effort to challenge industrial boundaries, achieving 923 patents and 20 technology awards.

And this innovative passion has perfectly presented on high quality products and outstanding services, we strive to offer ideal piping solutions to everyone.



SCALE

We adopt highly automated production lines with the most rigorous and comprehensive production control, and management system to handle such a powerful production.

Facility

11

Global production bases

5,200+

Production staffs

200

Hectares area totally

4,000+

Automated production lines

Capacity

Production Capacity

- Pipe: **3.2 billion** m/yr
- Fitting: **1.3 billion** pcs/yr

Storage Capacity

- **1,735,000 m³** ≈ 61,950 TEU (20 GP Containers)

RIIFO APPROVALS

RIIFO adhere to the concept of quality priority, all RIIFO products are produced under rigorous quality control with excelsior manufacturing. Until now, RIIFO has gained over 50 certificates, such as NSF, DVGW, AENOR, WRAS Watermark, etc. These certificates worldwide underline our technical and quality know-how, and we can provide you with 25 years system warranty backed up by an international insurance company.

Group Honor



Piping Systems





PROJECT REFERENCE

PROJECT REFERENCE



Yadot Tower, Ethiopia

Project: Yadot Tower Project
Type: Mix-use building
Year: 2021
Product: PVC System

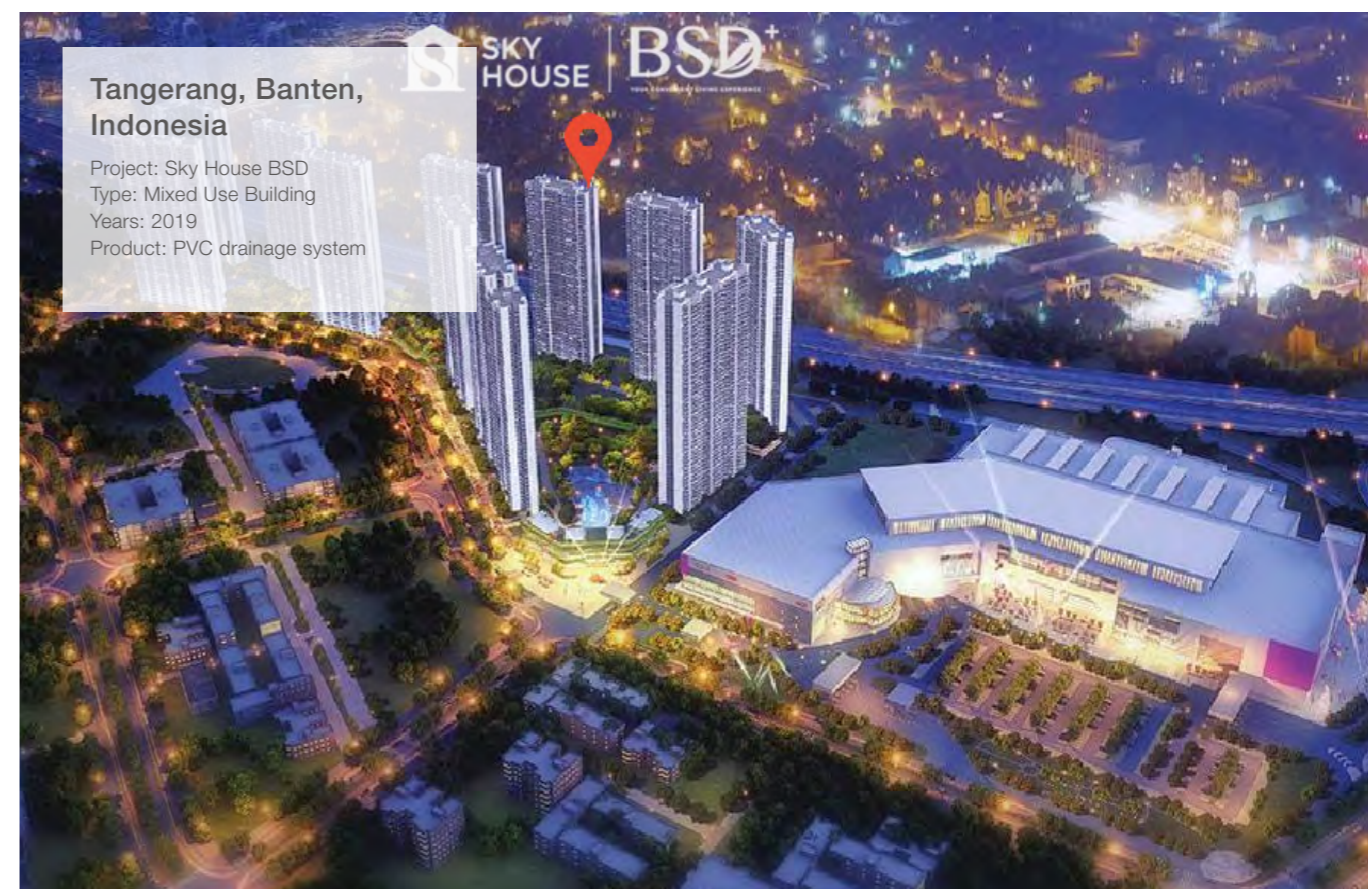

Tangerang, Banten, Indonesia

Project: Sky House BSD
Type: Mixed Use Building
Years: 2019
Product: PVC drainage system

PROJECT REFERENCE

Century Addis Real Estate, Ethiopia

Project: Century Addis Real Estate-Brass Apartment Project
Type: Apartment
Year: 2021
Product: PVC System



MDM, Ethiopia

Project: BOLE-RWANDA District Grand View Addis Project
Type: Apartment
Year: 2021
Product: PVC System+Multilayer Plumbing System

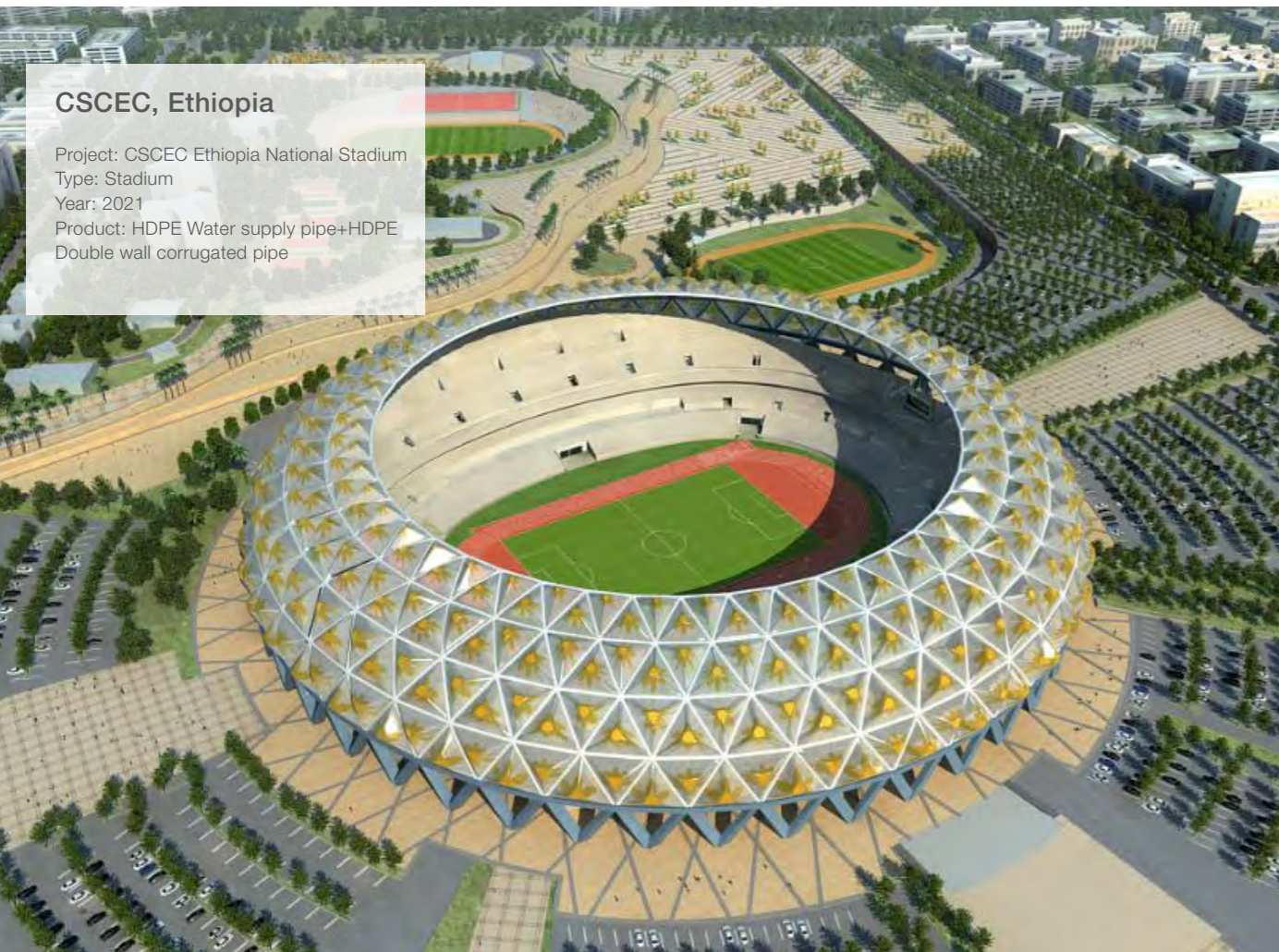

CSCEC, Ethiopia

Project: CSCEC Ethiopia National Stadium
Type: Stadium
Year: 2021
Product: HDPE Water supply pipe+HDPE Double wall corrugated pipe



Kidus Commercial Center, Ethiopia

Project: Kidus Commercial Center
Type: Apartment
Year: 2021
Product: PVC System

PROJECT REFERENCE

Ambon, Maluku, Indonesia

Project: Hotel Maxone
Type: 3 Star Hotel
Years: 2019
Product: PVC rigid conduit system



Tangerang, Banten, Indonesia

Project: Kingland Avenue
Type: Apartment
Years: 2019
Product: PVC rigid conduit system

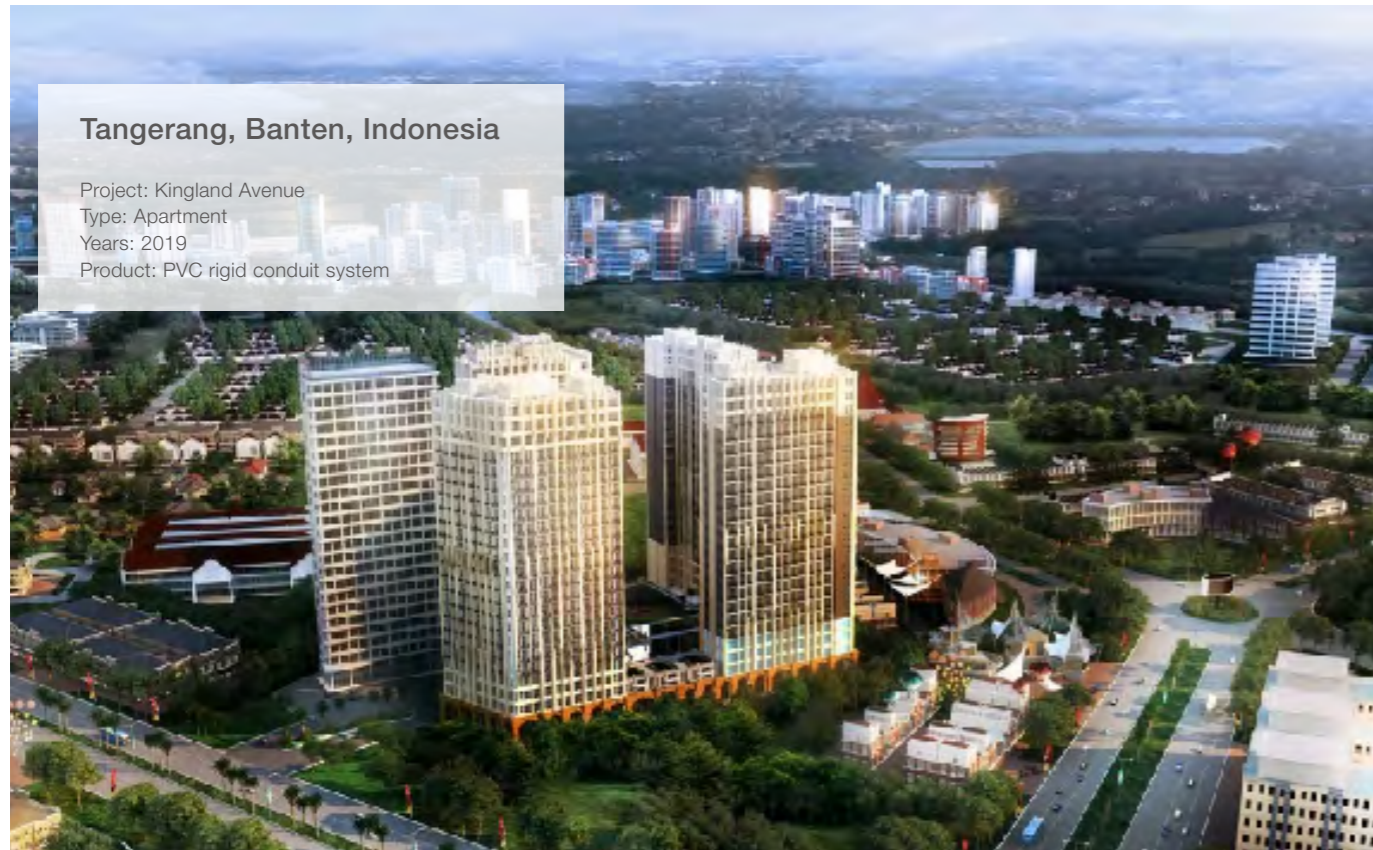

Banjarmasin, Kalimantan, Indonesia

Project: Tower ATC Airnav
Type: Airport
Years: 2020
Product: PVC rigid conduit system



Jakarta, Indonesia

Project: Perguruan Tinggi Ilmu Kepolisian
Type: Education
Years: 2020
Product: PVC rigid conduit system



RIIFO PVC RIGID CONDUIT

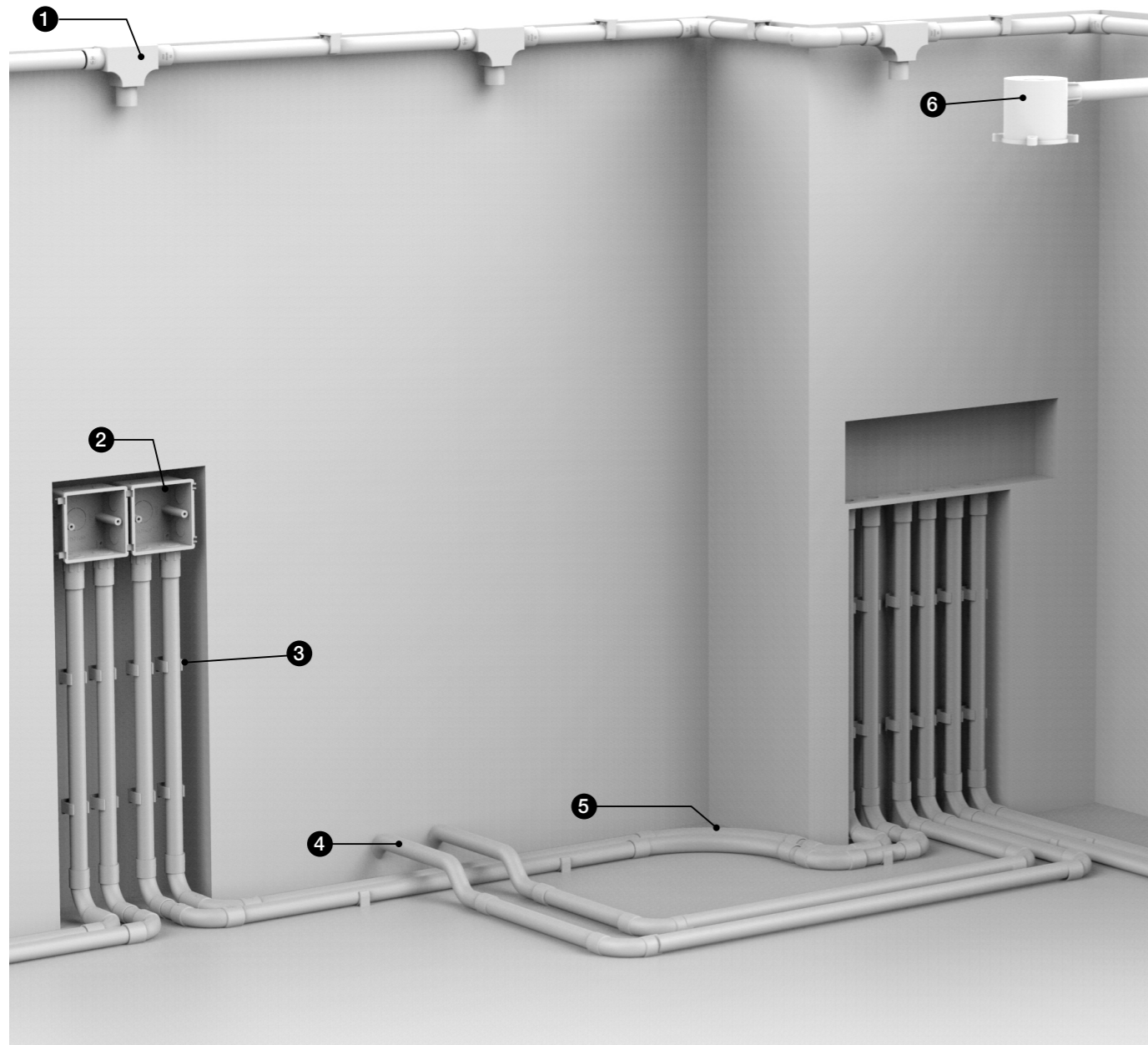

RIIFO PVC RIGID CONDUIT

RIIFO PVC rigid conduit is made of high-quality polyvinyl chloride resins and imported processing additives. It has an advantage of high impact resistance, strong flame retardancy and excellent cold bending performance, offering perfect solution for electrical safety in residential, commercial, and industrial use. RIIFO PVC rigid conduit is proven durable and effective for years of maintenance-free performance in underground.

Application

- Protect and manage indoor electrical wiring.
- Residential apartments, condominiums, public housing.
- Commercial shopping centers, office buildings, industrial use.
- Hospitals, schools, hotels and resorts.

Advantages

- | | |
|--|--|
|  Environmental protection and safety, recognized by EPD. |  Strong flame retardancy, extinguish after leaving the flame for 30 seconds. |
|  Good insulation, able to resist AC2000V voltage and insulation resistance more than $1 \times 10^8 \Omega$. |  High impact resistance and excellent cold bending performance, which can use less fittings and save more time. |
|  Low coefficient of roughness and smooth walls reduce friction during wire pull. |  Excellent physical and chemical properties ensure better tensile strength and durability. |
|  Light weight and convenient to transport. |  No need for special installation tools, ease and convenient of installation. |

RIIFO CONDUIT FITTINGS



Long Radius Bend

- Large arc of the fitting reduces threading resistance.
- Compared to ordinary elbows, it is convenient for electric wires installation



Multifunction Gang Box

- Compared to the ordinary design, the punching position has been moved up by 1cm, which means the slotting depth can reduce 1cm. It greatly improve the efficiency of installation.
- Offering the side punching and the front punching can meet various installation demands.
- The cylindrical connection can prevent cement and mud from getting into the box



Audio Cable Boxes

- Suit for home TV cable, network cable, digital cable connection box.
- Large diameter can accommodate a large number of wires.

TECHNICAL DATA

Performance Parameter

Term	Index	Term	Index
Density	1.35~1.55	Maximum working temperature /° C	60~70
Coefficient of linear expansion/($\times 10^{-5}$ m/m.° C)	6~12	Thermal conductivity /[W/(m.K)]	0.12~0.20
Tensile strength /Mpa	35~45	Coefficient of friction	0.45
Elongation at break/%	60~120	Insulation resistance (Ω)	$\geq 10^8$
Bending strength/MPa	65~110	Dielectric strength/(kV/mm)	≥ 2.0
Compressive strength/MPa	50~80	Oxygen Index/%	≥ 32
Shore hardness D	70~90	Self-extinguishing time from fire/sec	≤ 30

Specification	GY.205	GY.305	GY.405
Cold Bending Performance(-5° C)	$\Phi 16$ bending radius 84mm	$\Phi 20$ bending radius 105mm	$\Phi 25$ bending radius 131mm
Insulation Index	No breakdown in AC2000V and 50 Hz within 15mins, Insulation resistance $\geq 100M\Omega$		
Ring Stiffness	65 KN/m ²	110 KN/m ²	180 KN/m ²
Self-IgnitionTemperature	600° C	600° C	600° C

Product Category

Pipe	Classification	Application
205	Light	Suitable for laying in suspended ceilings
305	Medium	Suitable for laying in concrete, walls and floors
405	Heavy	Suitable for laying in concrete and floor in places with gravity
205	-5° C	Suitable for transportation or installation above -5° C
215	-15° C	Suitable for transportation or installation above -15° C

STANDARDS

IEC 61386-21

JG 3050-1998



SPECIFICATIONS

RIIFO Conduit Pipes

RIIFO Conduit Pipe GY.205



Specif.	Packing Specif. (m)	Color
PVC-GY.205-16x1.0	2.9/116(2.9*40)	White
PVC-GY.205-20x1.1	2.9/87(2.9*30)	White
PVC-GY.205-25x1.3	2.9/87(2.9*30)	White
PVC-GY.205-32x1.5	2.9/58(2.9*20)	White

RIIFO Conduit Pipe GY.305



Specif.	Packing Specif. (m)	Color
PVC-GY.305-16x1.2	2.9/116(2.9*40)	White
PVC-GY.305-16x1.3	2.9/116(2.9*40)	White
PVC-GY.305-20x1.3	2.9/87(2.9*30)	White
PVC-GY.305-20x1.5	2.9/87(2.9*30)	White
PVC-GY.305-25x1.5	2.9/87(2.9*30)	White
PVC-GY.305-25x1.6	2.9/87(2.9*30)	White
PVC-GY.305-32x1.7	2.9/58(2.9*20)	White
PVC-GY.305-32x1.8	2.9/58(2.9*20)	White
PVC-GY.305-40x2.0	2.9/29(2.9*10)	White
PVC-GY.305-50x2.2	2.9/14.5(2.9*5)	White

RIIFO Conduit Pipe GY.405



Specif.	Packing Specif. (m)	Color
PVC-GY.405-16x1.6	2.9/116(2.9*40)	White
PVC-GY.405-20x1.8	2.9/87(2.9*30)	White
PVC-GY.405-20x2.0	2.9/87(2.9*30)	White
PVC-GY.405-25x1.9	2.9/87(2.9*30)	White
PVC-GY.405-32x2.3	2.9/58(2.9*20)	White
PVC-GY.405-40x2.3	2.9/29(2.9*10)	White
PVC-GY.405-50x2.3	2.9/14.5(2.9*5)	White

Coupling

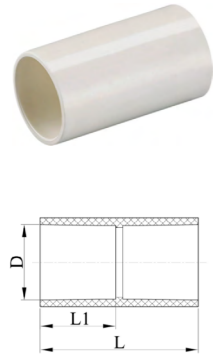

Specif.	pcs/box	pcs/ctn.	D	L	L1
F20-S16x16	300	1800	16	33.5	16
F20-S20x20	160	960	20	42	20
F20-S25x25	80	480	25	52	25
F20-S32x32	75	600	32	66	32
F20-S16x16(Lengthened)	200	1200	16	45	21.5
F20-S20x20(Lengthened)		720	20	55	26.5
F20-S40x40		512	40	67	32
F20-S50x50		288	50	67	32

Application: Connect PVC conduit pipe of the same specification on both sides.

Reducing coupling

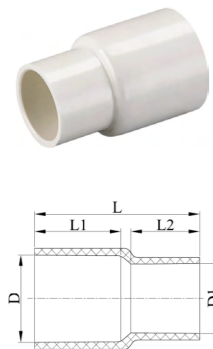

Specif.	pcs/box	pcs/ctn.	DxD1	L	L1	L2
F20-S20x16	180	1080	20x16	37	20	16
F20-S25x20	110	660	25x20	48	25	20
F20-S32x25	100	800	32x25	60	32	25

Application: Connect PVC conduit pipe of the different specification on both sides.

Terminal adapter

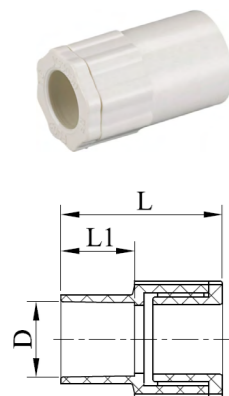

Specif.	pcs/box	pcs/ctn.	D	L	L1
F20-J16x16	280	1680	16	33	16
F20-J20x20	150	900	20	37	20
F20-J25x25	90	540	25	43	25
F20-J32x32	85	680	32	52	32
F20-J40x40		288	40	53	32
F20-J50x50		500	50	53	32

Application: Connect PVC conduit pipe one side, and connect gang box the other side.

Reducing terminal adapter



Specif.	pcs/box	pcs/ctn.	D1xD	L	L1
F20-J20x16	180	1080	20x16	34.5	16
F20-J25x20	100	600	25x20	40	20

Application: Connect PVC conduit pipe one side, and connect gang box the other side.

Inspection tee

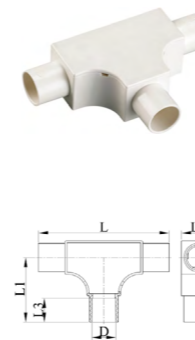

Specif.	pcs/box	pcs/ctn.	D	L	L1	L2	L3
F20-GT16x16x16	60	480	16	100	49.5	27.8	16
F20-GT20x20x20	40	320	20	109	54	32	20
F20-GT25x25x25	25	200	25	116	57.5	39	25

Application: Connect PVC conduit pipe of the same specification on three sides. The cover is detachable, which is convenient for checking the circuit, threading, branching and transitional wiring.

Elbow with cover

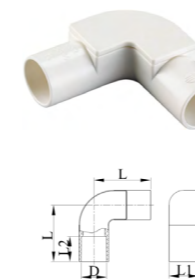

Specif.	pcs/box	pcs/ctn.	D	L	L1	L2
F20-GL16x16	100	600	16	41.5	19	16
F20-GL20x20	60	360	20	45	23.5	20
F20-GL25x25	40	240	25	50	29	25
F20-GL32x32	30	240	32	67.5	36.5	32

Application: Connect PVC conduit pipe of the same specification on both sides. The cover is detachable, which is convenient for checking the circuit, threading, branching and transitional wiring;

Tee

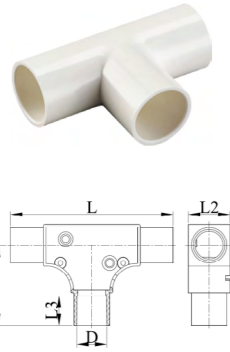

Specif.	pcs/box	pcs/ctn.	D	L	L1	L2
F20-T16x16x16	120	720	16	53	26.5	16
F20-T20x20x20	60	360	20	70	35	20
F20-T25x25x25	60	480	25	80	40	25
F20-T32x32x32	32	256	32	100	50	32
F20-T40x40x40	15	120	40	108	54	32
F20-T50x50x50	12	96	50	118	59	32

Application: Connect PVC conduit pipe of the same specification on three sides.

Elbow

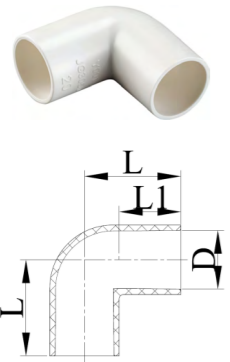

Specif.	pcs/box	pcs/ctn.	D	L	L1
F20-L16x16	180	1080	16	28	16
F20-L20x20	100	600	20	33	20
F20-L25x25	55	330	25	41	25
F20-L32x32	50	400	32	50.5	32
F20-L40x40	24	192	40	54	32
F20-L50x50	18	144	50	60	32

Application: Connect PVC conduit pipe of the same specification on both sides.

Long radius bend

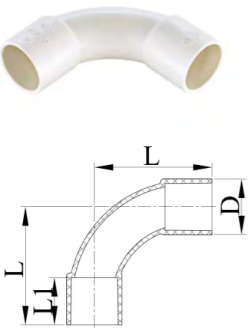

Specif.	pcs/box	pcs/ctn.	D	L	L1
F20-DL16x16	140	840	16	43.3	16
F20-DL20x20	70	420	20	50	20
F20-DL25x25	85	680	25	60	25
F20-DL32x32	30	240	32	78.7	32
F20-DL40x40	15	120	40	91	32
F20-DL50x50	11	88	50	91	32

Application: Connect PVC conduit pipe of the same specification on both sides. Large bends and low coefficient of roughness reduce friction during wire pull.

118 PVC concealed box

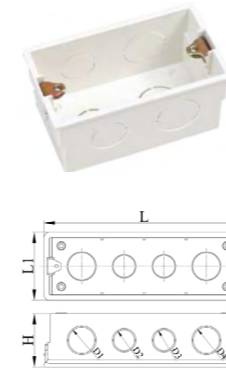

Specif.	pcs/ctn.	H	L	L1	D1	D2	D3	D4
F20-106x61x50 II Φ20Φ25	100	50	108	63.5	20	25		
F20-143x61x50 II Φ20Φ25	50	50	145	63.5	20	25	20	
F20-184x61x50 II Φ20Φ25	30	50	186	63.5	25	20	20	25
F20-100x61x50 III Φ20Φ25	60	50	99.6	61	20	25		
F20-136x61x50 III Φ20Φ25	45	50	135.6	61	20	25	20	
F20-177x61x50 III Φ20Φ25	30	50	177.1	61	25	20	20	25

Application: Installed and fixed on the panel, wall, and is a terminal bottom box for switches, lamps, sockets and wiring in the box.

Surface installation gang box



Specif.	pcs/ctn.	H	L	D1	D2
F20-86x86x40	120	40	86	25	20

Application: Installed and fixed on the panel, wall, and is a terminal bottom box for switches, lamps, sockets and wiring in the box.

Octagonal box

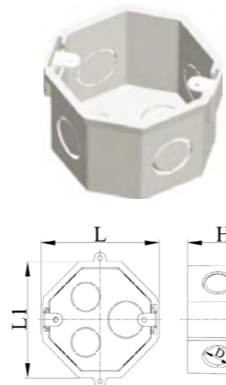

Specif.	pcs/ctn.	H	L	L1	D
F20-77x77x50 II Φ20	60	50	82.1	79.6	20
F20-77x77x60 II Φ20	40	60	82.1	79.6	20
F20-77x77x70 II Φ20	40	70	82.1	79.6	20

Application: Installed and fixed on the panel, wall, and is a terminal bottom box for switches, lamps, sockets and wiring in the box;

Multifunction Gang Box

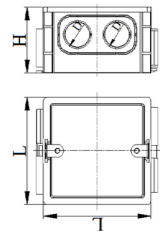

Specif.	pcs/ctn.	H	L	D
F20-77x77x50 II Φ20	60	50	81.6	20
F20-77x77x38 II Φ20	80	38	81.6	20

Application: Installed and fixed on the panel, wall, and is a terminal bottom box for switches, lamps, sockets and wiring in the box.

Audio Cable Boxes

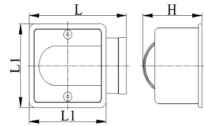

Specif.	pcs/ctn.	H	L	L1
F20-77x77x50 I	160	58	103	78

Application: Suit for home TV cable, network cable, digital cable connection box.

Two way through round junction box

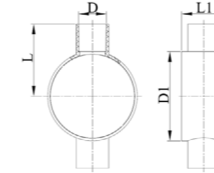

Specif.	pcs/ctn.	D	D1	L1	L
F20-65x35Φ16	378	16	65	35	48
F20-65x35Φ20	378	20	65	35	52.5
F20-65x35Φ25	288	25	65	35	57.5
F20-65x65Φ16	175	16	65	65	96
F20-65x65Φ20	175	20	65	65	105
F20-65x65Φ25	150	25	65	65	115

Application: Round wire box with socket, connect PVC conduit pipe on both sides.

Two way angle round junction box

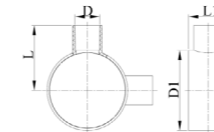

Specif.	pcs/ctn.	D	D1	L1	L
F20-65x35Φ16	378	16	65	35	48
F20-65x35Φ20	315	20	65	35	52.5
F20-65x35Φ25	315	25	65	35	57.5
F20-65x65Φ16	175	16	65	65	48
F20-65x65Φ20	175	20	65	65	52.5
F20-65x65Φ25	315	25	65	65	57.5

Application: Round wire box with socket, connect PVC conduit pipe on both sides.

One way round junction box

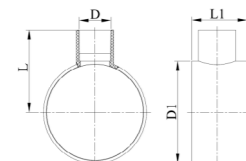

Specif.	pcs/ctn.	D	D1	L1	L
F20-65x35Φ16	315	16	65	35	48
F20-65x35Φ20	315	20	65	35	52.5
F20-65x35Φ25	315	25	65	35	57.5
F20-65x65Φ16	200	16	65	65	48
F20-65x65Φ20	180	20	65	65	52.5
F20-65x65Φ25	150	25	65	65	57.5

Application: Round wire box with socket, connect PVC conduit pipe on one side.

Three way round junction box

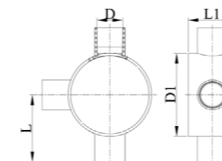

Specif.	pcs/ctn.	D	D1	L1	L
F20-65x35Φ16	315	16	65	35	48
F20-65x35Φ20	261	20	65	35	52.5
F20-65x35Φ25	216	25	65	35	57.5
F20-65x65Φ16	175	16	65	65	96
F20-65x65Φ20	150	20	65	65	105
F20-65x65Φ25	144	25	65	65	115

Application: Round wire box with socket, connect PVC conduit pipe on three sides.

Four way through round junction box

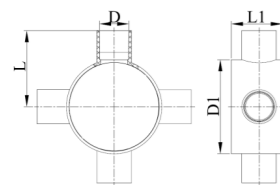

Specif.	pcs/ctn.	D	D1	L1	L
F20-65x35Φ16	315	16	65	35	48
F20-65x35Φ20	261	20	65	35	52.5
F20-65x35Φ25	216	25	65	35	57.5
F20-65x65Φ16	175	16	65	65	96
F20-65x65Φ20	150	20	65	65	105
F20-65x65Φ25	120	25	65	65	115

Application: Round wire box with socket, connect PVC conduit pipe on four sides.

Lid cover



Specif.	pcs/box	pcs/ctn.	L	D
F20-D65 II	400	2400	4.7	65
F20-D65		800	8	65

Application: The lid cover of round wire box.

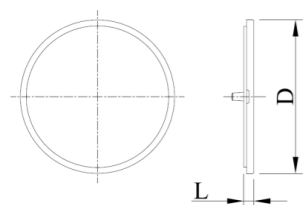

Pipe cutter



Specif.	pcs/ctn.
GJ IV	40

PVC adhesive



Specif.	pcs/ctn.
PVC adhesive 100ML	24
PVC adhesive 250ML	24
PVC adhesive 500ML	12

Row clip



Specif.	pcs/box	pcs/ctn.
F20-D16	100	600
F20-D20	60	360

Bending spring



Specif	pcs/ctn.
WH205-D16	80
WH205-D20	50
WH205-D25	30
WH205-D32	18
WH305-D16	80
WH305-D20	50
WH305-D25	30
WH305-D32	18
WH405-D16	80
WH405-D20	50
WH405-D25	30
WH405-D32	18



INSTALLATION

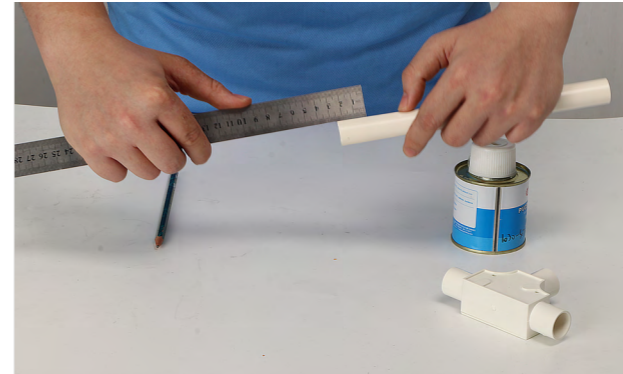

STEP 1: Measuring

Wipe the surface of pipe and fitting to keep clean. Measure the installation depth of pipe and fitting.



STEP 2: Marking

Mark down the depth of installation

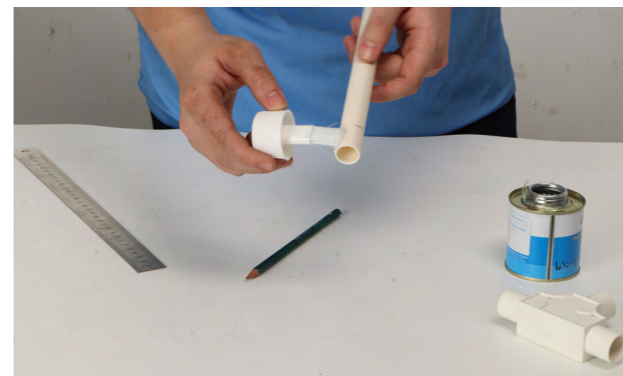

STEP 3: Applying PVC glue

Apply the pipe and fitting evenly with PVC glue.

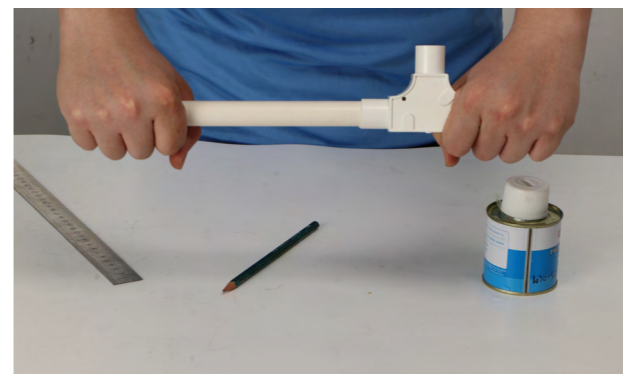

STEP 4: Connection

After the pipe and fitting are coated with glue, insert them quickly, and rotate them to distribute the glue evenly to ensure a firm connection. After the installation is complete, wipe the overflowing glue.